

## Inside View STBD

### Step 1

Install claps on the back leg/tube of the tower.  
Tighten bolts only enough to hold clamps in place.

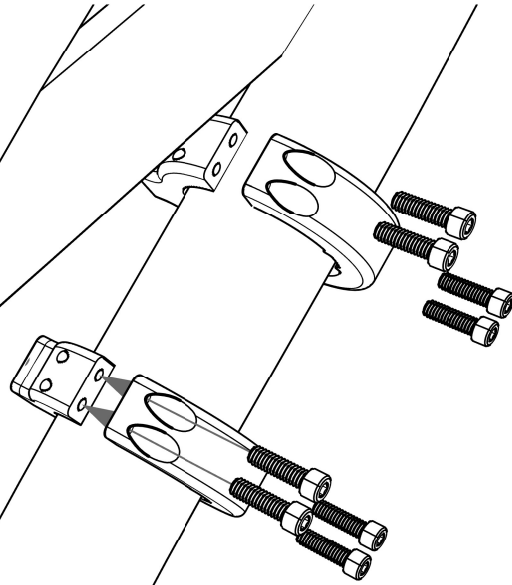

## Outside View STBD

### Step 2

Mount the base plate

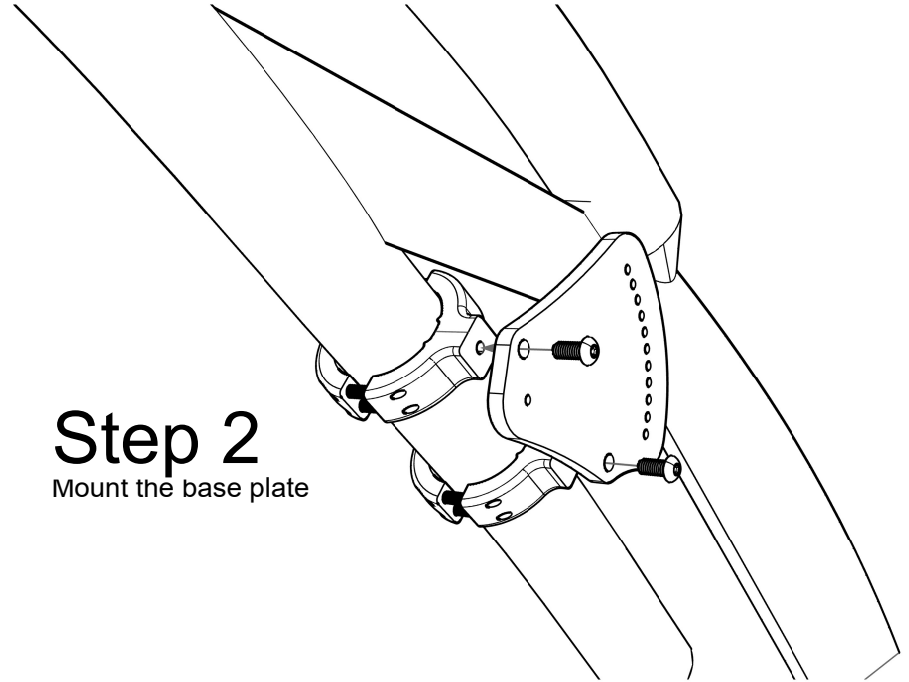

## Outside View STBD

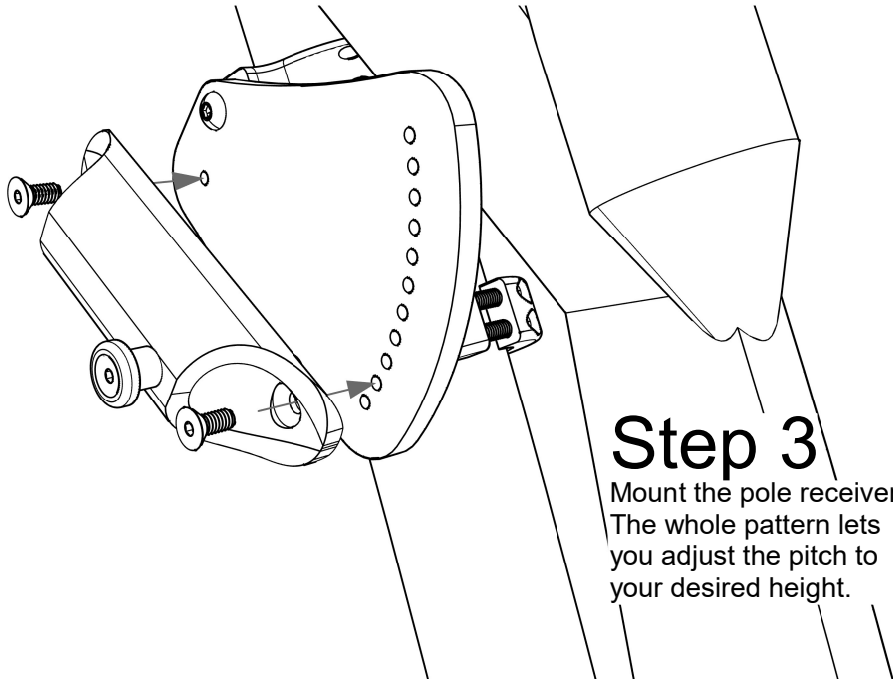

### Step 3

Mount the pole receiver.  
The whole pattern lets you adjust the pitch to your desired height.

## Outside View STBD

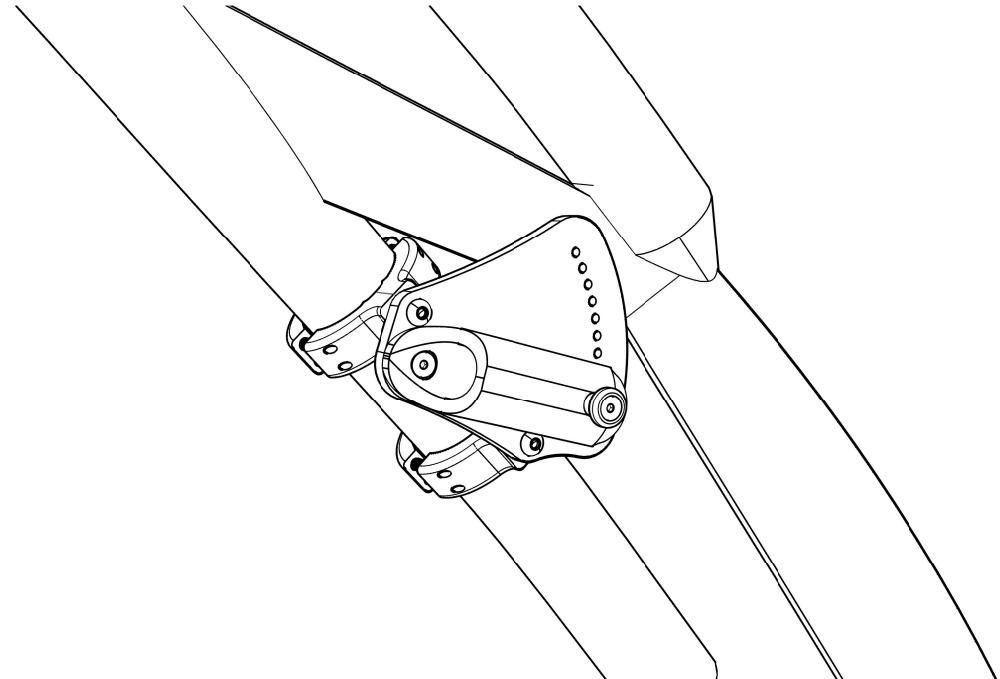

# Step 4 Adjust The Angle/Width Of The Shade Sail

Once clamps are loosely in place, adjust the width by inserting the carbon pole (fully extended) and rotating the hardware to get the poles' end's correct width.

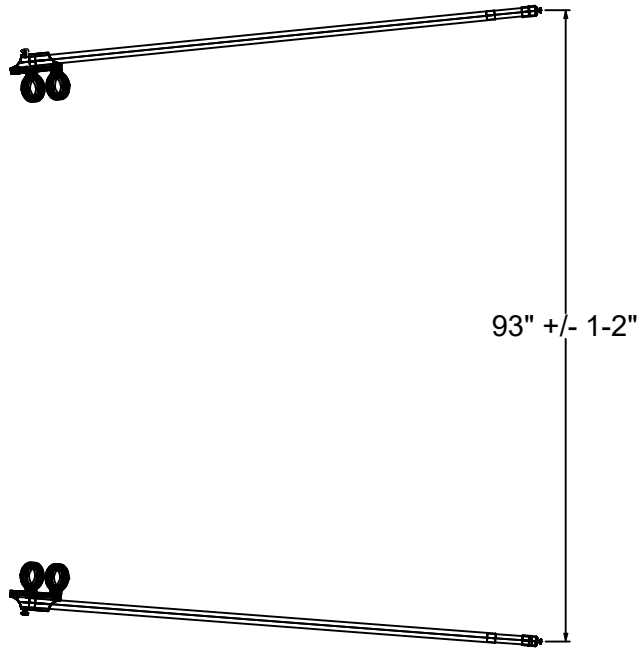

5' Poles

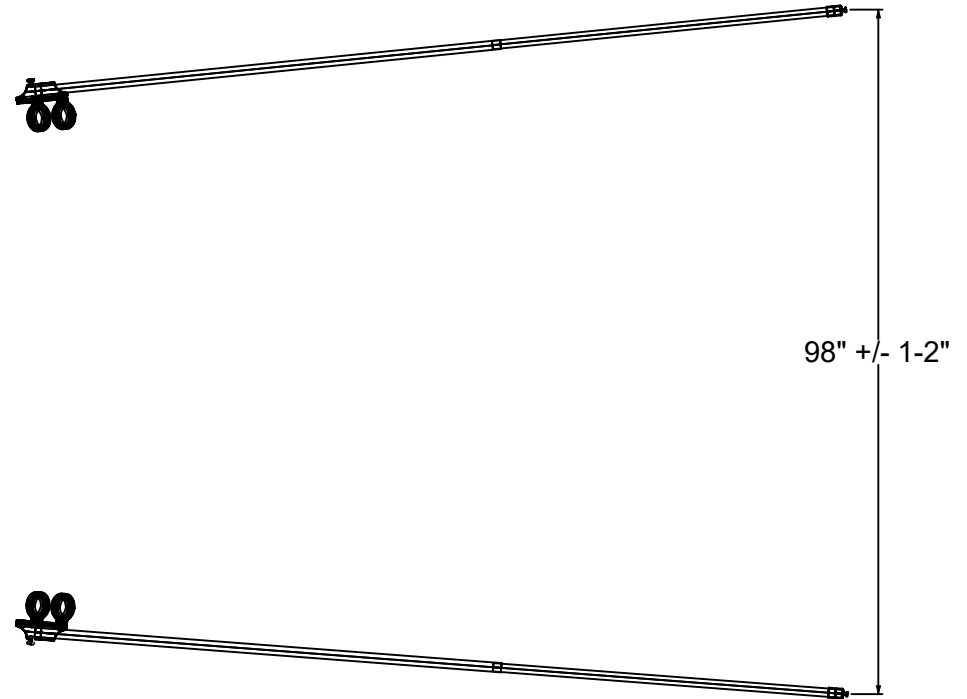

8' Poles

Tighten all bolts and verify that they are tight before each use. If you have any questions, please feel free to call, text, or email.

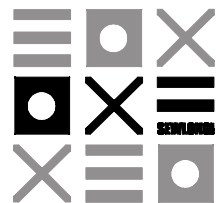

Sewlong | Custom Covers

801-262-4017 - Text & Call

[covers@sewlong.com](mailto:covers@sewlong.com)