

MB Stelth Tower FCTv3 Intallation

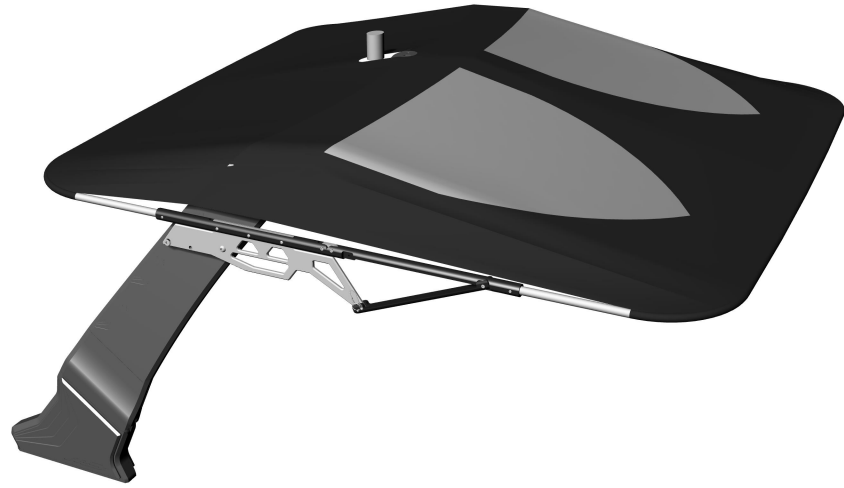

#1

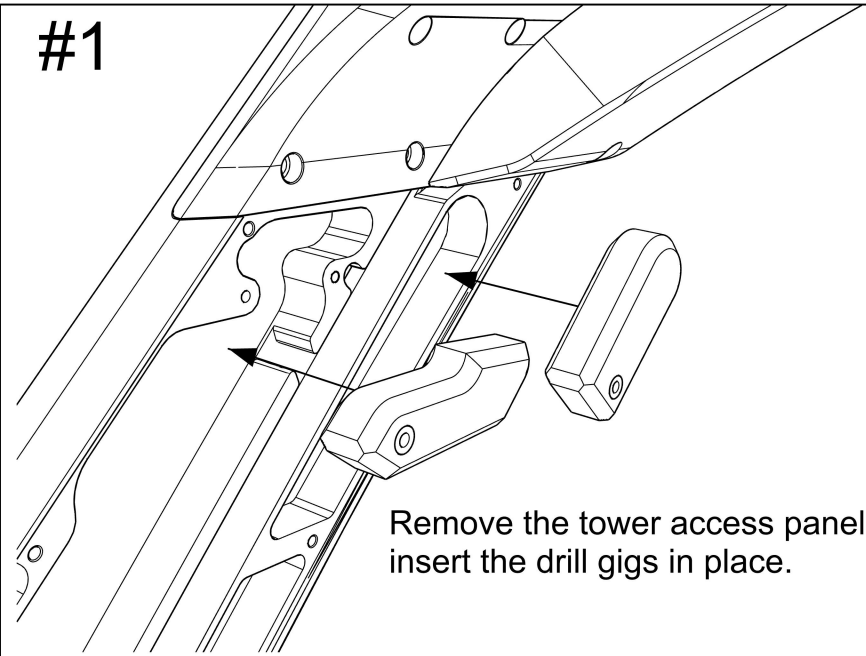

Remove the tower access panel and insert the drill jigs in place.

#2

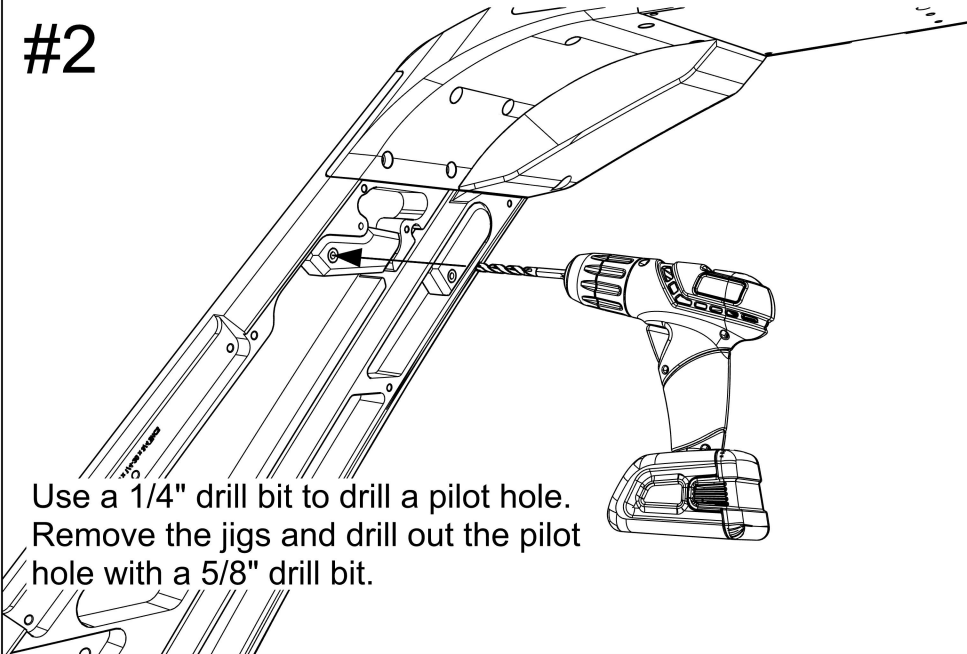

Use a 1/4" drill bit to drill a pilot hole. Remove the jigs and drill out the pilot hole with a 5/8" drill bit.

#3

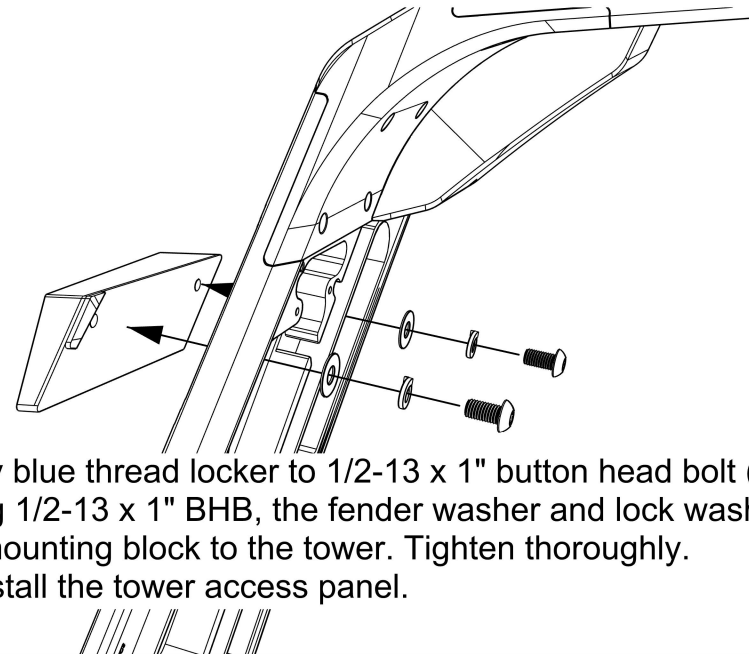

Apply blue thread locker to 1/2-13 x 1" button head bolt (BHB). Using 1/2-13 x 1" BHB, the fender washer and lock washer bolt the mounting block to the tower. Tighten thoroughly. Reinstall the tower access panel.



3555 s Main St. SLC, UT 84115

SEWLONG.com

Covers@SewLong.com 801-262-4017

#4

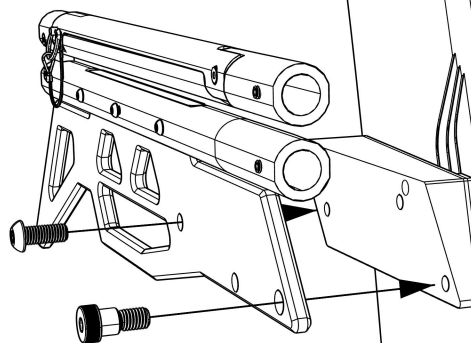

Using a 5/8" shoulder bolt and 1/2-13x1.25" BHB install the tube kit assembly. Repeat on the STBD side.

#5

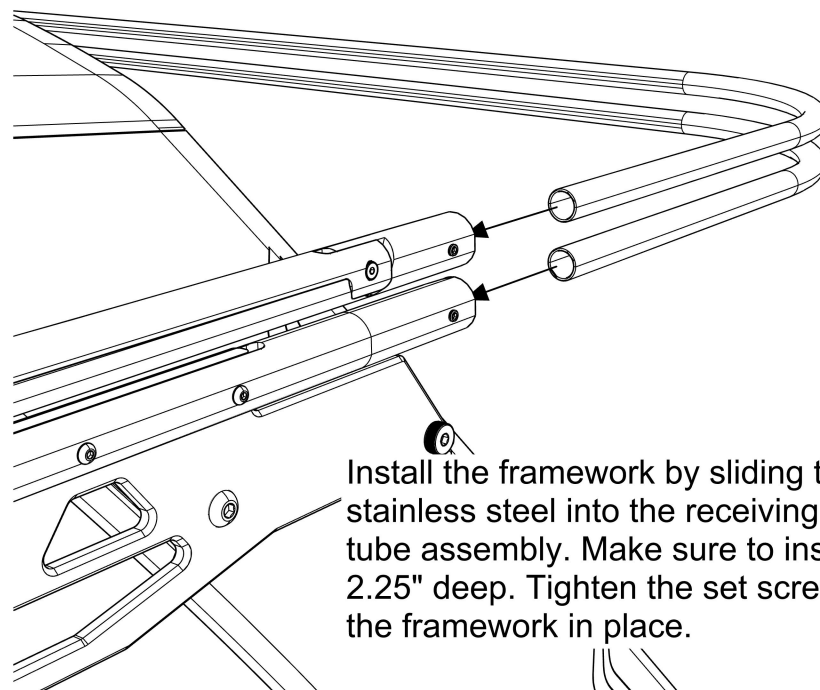

Install the framework by sliding the 1" stainless steel into the receiving end of the tube assembly. Make sure to insert it fully, 2.25" deep. Tighten the set screw to hold the framework in place.

#6

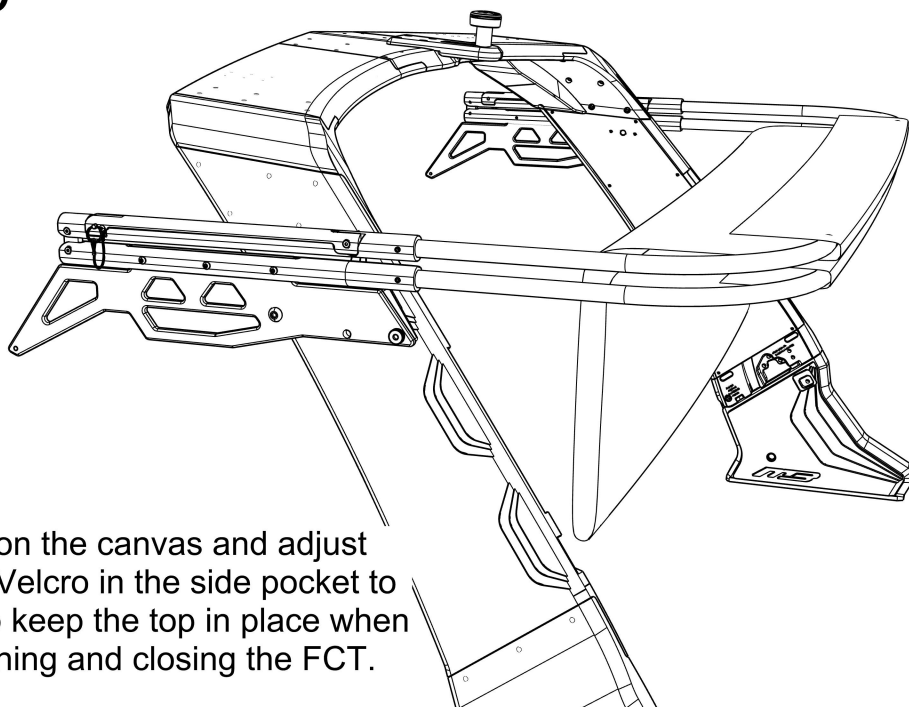

Zip on the canvas and adjust the Velcro in the side pocket to help keep the top in place when opening and closing the FCT.

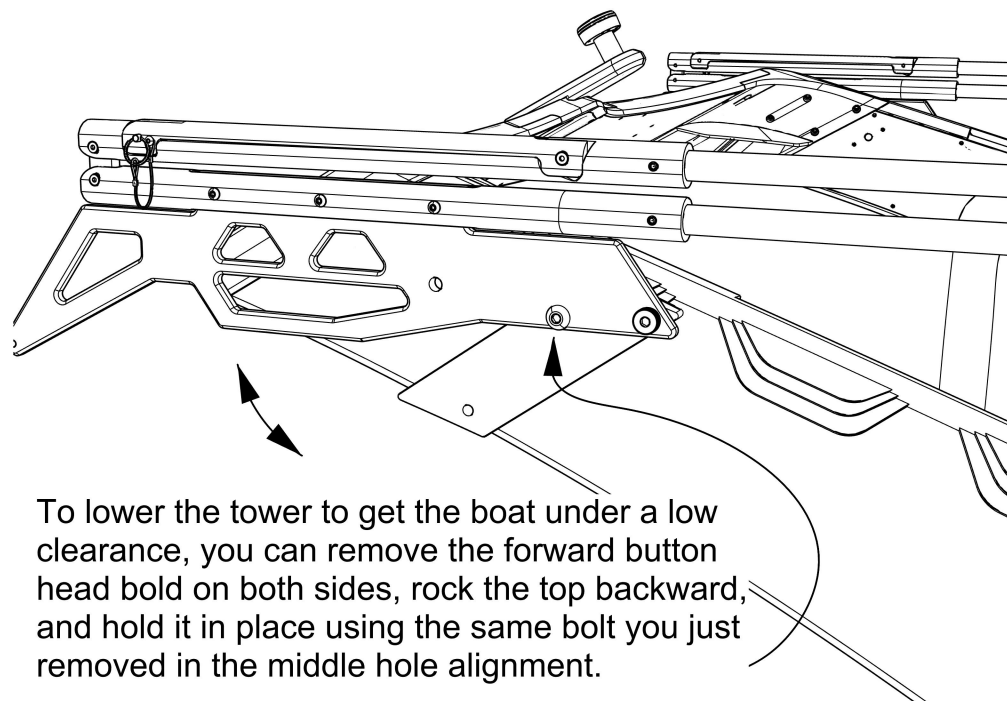

To lower the tower to get the boat under a low clearance, you can remove the forward button head bolt on both sides, rock the top backward, and hold it in place using the same bolt you just removed in the middle hole alignment.