

SewLong Tower Clamp Shade Sail 2018 Nautique G

#1

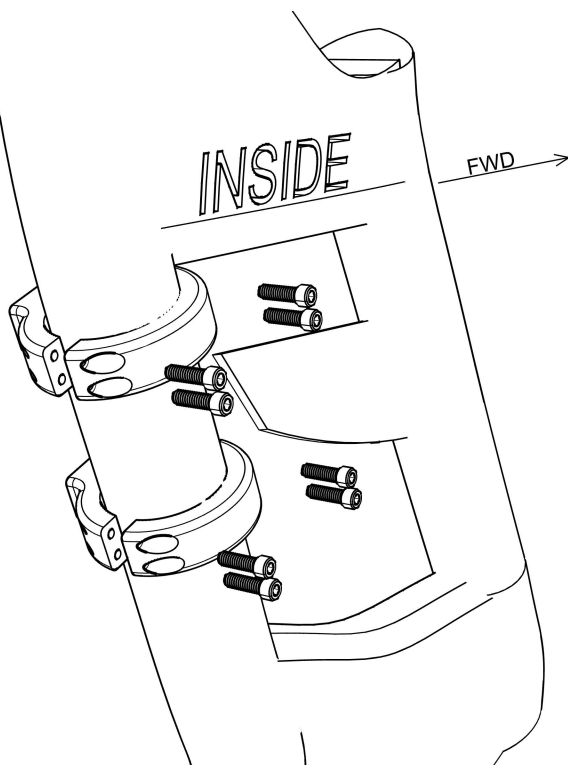

Bolts:
1/4-20 x 7/8" SHB

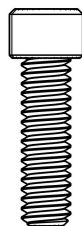

Install Clamp on the AFT Bar of tower as leaving just a small gap between the top clamp and corss plate of the tower. Leave slightly loose for future adjustment.

Bolts:
1/4-20 x 1/2" SFHB

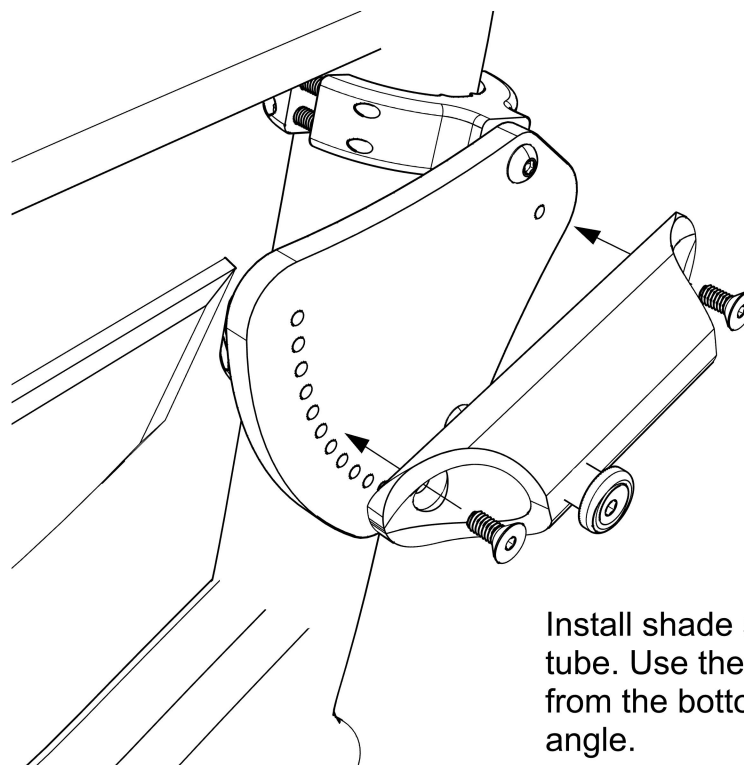
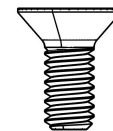

Install shade sail receiving tube. Use the seventh (7) hole from the bottom for the proper angle.

#2

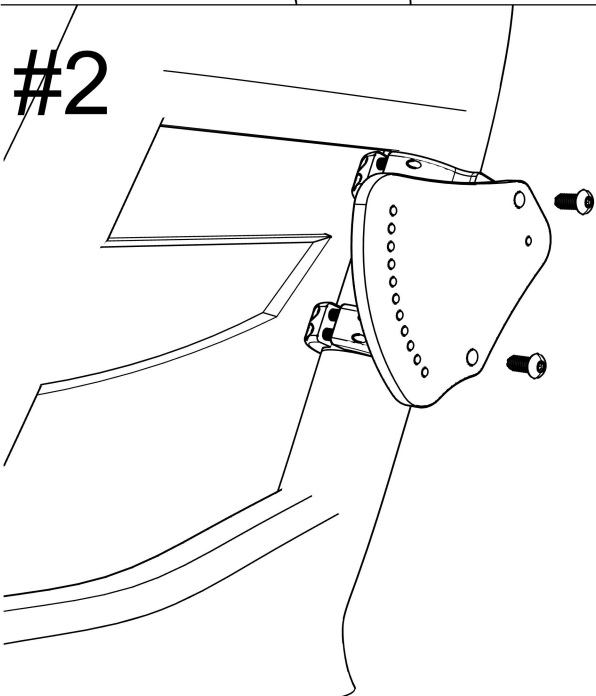

Install the shade sail fin plate. Make sure the plate is oriented, as shown here.

Bolts:
5/16-18 x 3/4" BHB

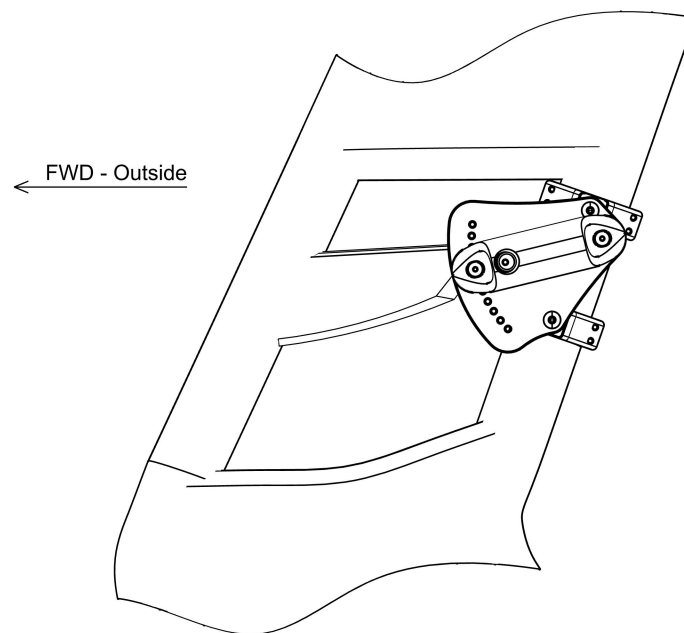

#4 Adjust The Angle/Width Of The Shade Sail

Once clamps are loosely in place, adjust the width by inserting the carbon pole (fully extended) and rotating the hardware to get the poles' end's correct width.

5' Poles 2018 G Tower

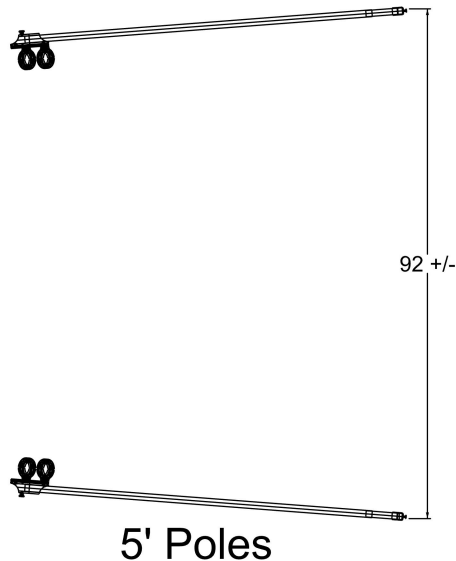

8' Poles 2018 G Tower

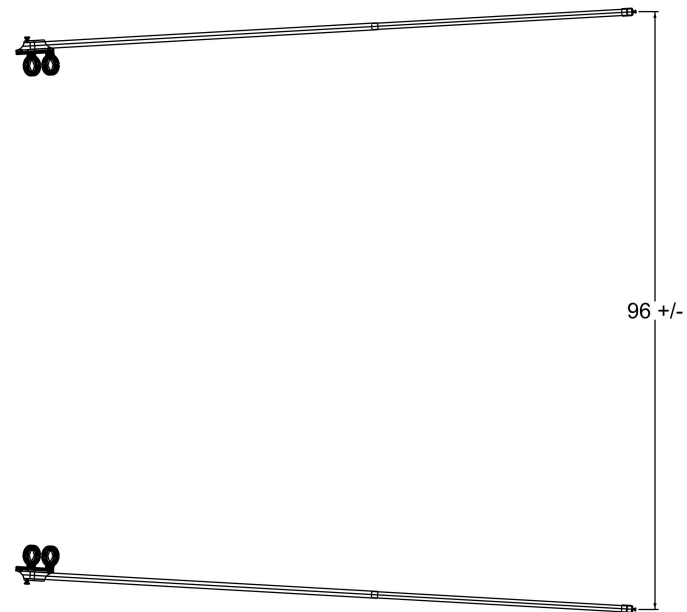

Tighten all bolts and verify that they are tight before each use. If you have any questions, please feel free to call, text, or email.

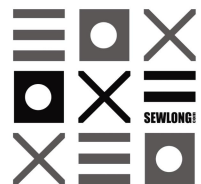

Sewlong | Custom Covers
801-262-4017 - Text & Call
covers@sewlong.com